

# Roller Blinds Window Covering

HunterDouglas® EOS®500 roller blinds offer superior, high-quality operation, accompanied by an extensive range of fabrics to both control glare and prevent the build-up of heat.

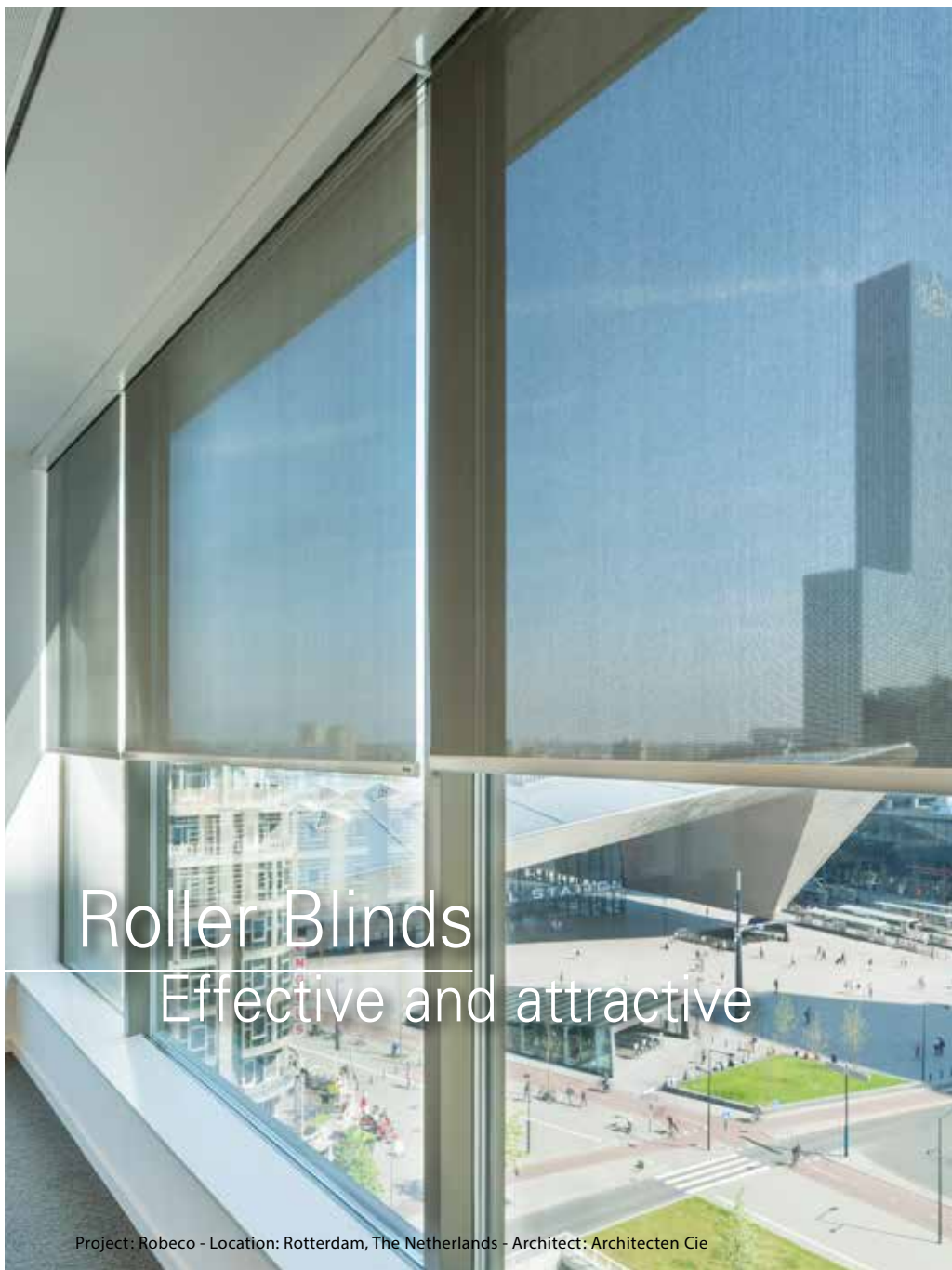

**HunterDouglas**   
Architectural



## Roller Blinds

### Effective and attractive

Project: Robeco - Location: Rotterdam, The Netherlands - Architect: Architecten Cie



Project: InterContinental Dubai Marina  
Location: Dubai, United Arab Emirates - Architect: Drawlink Gro

The HunterDouglas® EOS®500 range of project roller blinds offers a wide choice of durable fabrics, which have been woven with great care, using the correct techniques and treated for the best result. The roller blinds are extremely versatile and combine many potential applications with a powerful, user-friendly operating system with which to control heat build-up and glare from sunlight.

#### QUALITY AND COMFORT

Roller blinds have a significant effect on the comfort in a sleek interior, whether it's a small office or a huge public space.

The HunterDouglas® project range:

- Is suitable for use in almost any building, be it a new-build or refurbishment project
- Consists of sleek, flame-retardant, recyclable fabrics which keep their shape
- Contains the highest-performing fabrics in thermal insulation, which can subsequently contribute to a higher score in Green Building

certification

- Has a simple, maintenance-free operating system
- Is constructed from modular components for fast and simple installation

#### FUNCTIONALITY

The HunterDouglas® EOS®500 range of project roller blinds consists of:

- A transparent project range
- A black-out project range

Both fabric ranges make use of the same assembly and operating systems. The EOS®500 roller blind system's design depends on the full dimensions, while the technical features

# EOS<sup>®</sup> 500 Roller Blinds

## EASY INSTALLATION

Assembly on the window frame, the wall or the ceiling - everything is possible with the HunterDouglas<sup>®</sup> EOS<sup>®</sup>500. The simple, patented assembly system offers ease of installation and operation as well as a long-lasting maintenance-free system. Patented features include:

- Modular installation of the chain operating system, which can be placed both to the right and the left
- A universal spring-loaded plug in the roller tube, which aids fast assembly
- Exact alignment of the bottom rail thanks to easily-connected multiple roller blinds
- A maximum of three systems can be connected to a single point of operation (both manual and motorised).

## THE STRENGTHS OF EOS<sup>®</sup>500

The sleek design, smooth operating and wide range of applications make the EOS<sup>®</sup>500 an attractive product for any project, even those with large windows.

HunterDouglas<sup>®</sup> Roller Blinds give the feeling of personal involvement and allow a pleasant view. Moreover, the roller blinds also prevent heat from the sun.

If you would like to know what the most sustainable solution is for your project, you can be sure that Hunter Douglas has the knowledge and expertise to give you the right advice.

## FACT AND FIGURES

The HunterDouglas<sup>®</sup> EOS<sup>®</sup>500 roller blinds:

- Tailor-made to clients' specifications
- Range of fabrics includes a large selection with a glare classification of 3 and 4
- Contribute to the reduction of indoor heat accumulation

**HunterDouglas** 





## STANDARD AND COUNTER-ROLLING

The HunterDouglas® blind can be unrolled from the system in two ways, namely:

- Standard rolling (back rolling)
- Counter rolling (front rolling)

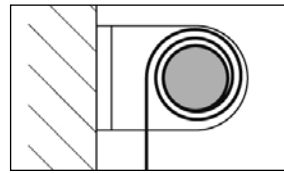

Standard rolling

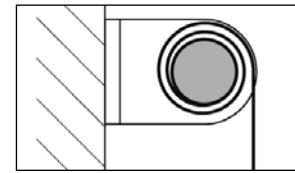

Counter rolling

## OPERATING SYSTEM

HunterDouglas® EOS®500 roller blinds can be operated in a number of ways:

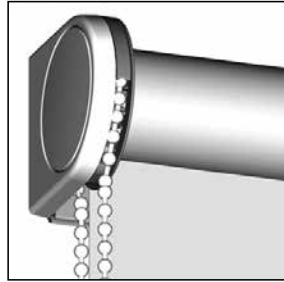

Chain operation

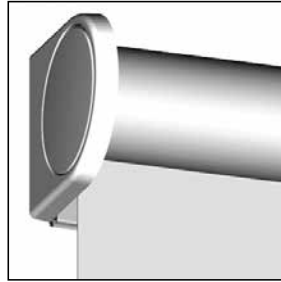

LiteRise\*\*

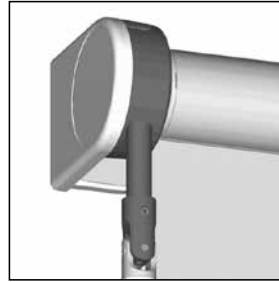

Crank rod

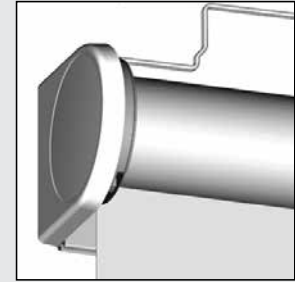

### MOTORISED

- Motorised 24V
- Motorised 230V

\* LiteRise® is an extremely user-friendly operating system with which to bring the bottom rail to the desired height.

## GUIDANCE SYSTEM

Various types of guidance systems have been developed for the EOS®500 roller blinds to suit a variety of areas of application and desired effects.

Guidance systems are generally used in the case of high, narrow windows, extreme internal airflow, black-out or for a more stable construction

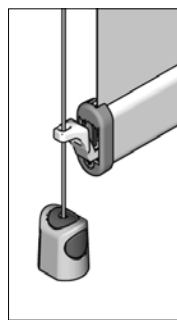

Daytime cable guidance

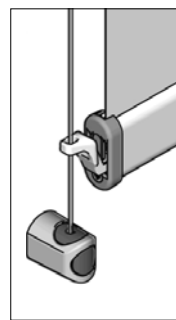

Standard side guidance

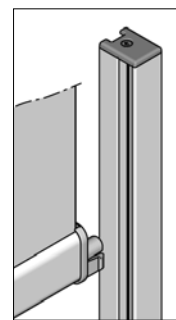

Daily cable guidance

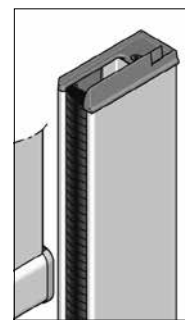

Black-out side guidance

## BOTTOM RAIL

The bottom rail is available in three finishes.

### S-SERIES

- Standard : Oval bottom rail
- Optional : Rectangular XL or Oval XL

### M-SERIES

- Standard : Rectangular XL

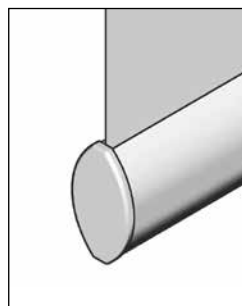

Oval bottom rail (266 gr/m)

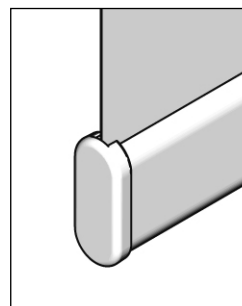

Rectangular XL (390 gr/m)

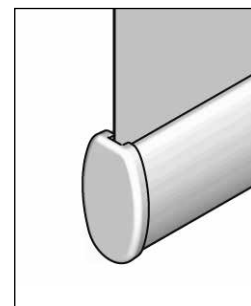

Oval XL bottom rail (390 gr/m)

- Optional bottom rail : Oval XL or Oval

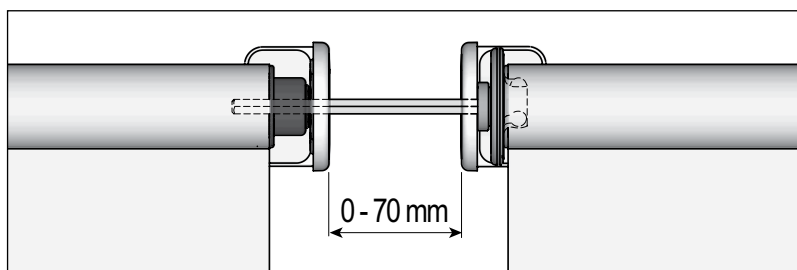

## HANGING SYSTEMS

The HunterDouglas® EOS®500 roller blind range consists of three hanging systems: brackets, mounting profiles and cassettes. Please see below the various finishes with the accompanying dimensions for each system.

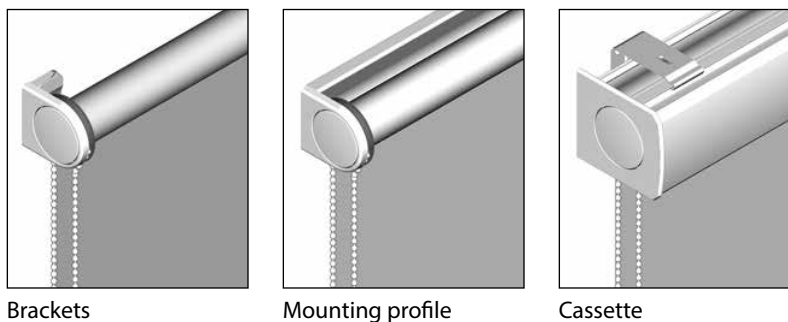

Brackets

Mounting profile

Cassette

## DIMENSIONS

The construction and dimensions of the S Series (up to sizes of 2500 x 3000 mm\*) are as follows:

### Brackets (5-410)

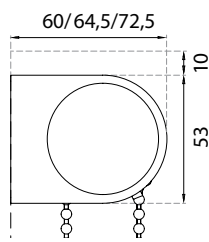
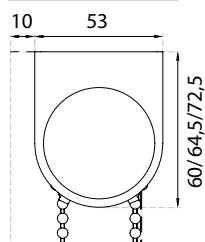

### Mounting profile (5-420)

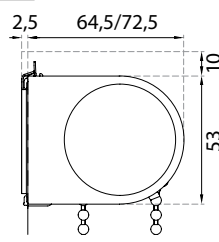
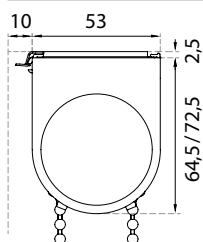

### Cassette (5-470/490)

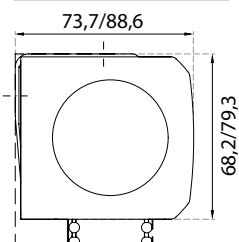

The construction and dimensions of the M Series (up to sizes of 3600 x 4000 mm\*) are as follows:

### Brackets (5-10)

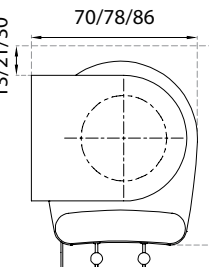
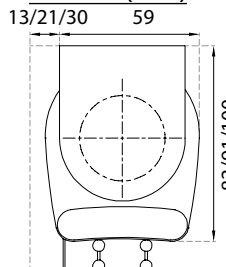

### Mounting profile (5-20)

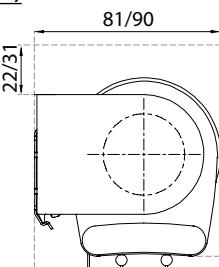
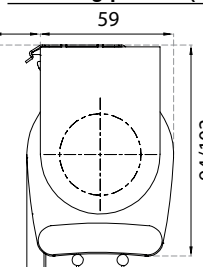

### Cassette (5-50/60)

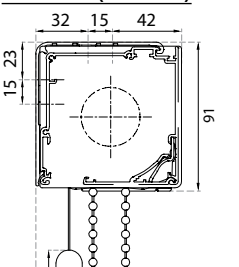

\*Depending on the operating system and the type of fabric used.

Should larger sizes or special solutions (such as for a skylight) be desired, please get in touch with your nearest Hunter Douglas branch.

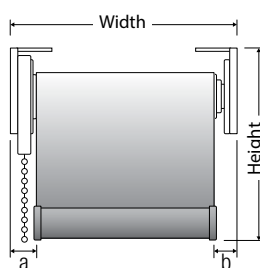

### WIDTH OF S SERIES SYSTEM (Dimensions dependent on the type of roller blind system)

	Chain operation	LiteRise®	Motorised 24V	Motorised 230V	Crank rod
a	17 mm	13 mm	16/24/25 mm	-	-
b	10/15 mm*	10 mm	10/15 mm*	-	-

### WIDTH OF M SERIES SYSTEM (Dimensions dependent on the type of roller blind system)

	Chain operation	LiteRise®	Motorised 24V	Motorised 230V	Crank rod
a	21 mm	-	16 mm	28 mm	30 mm
b	17/18/19/20 mm*	-	17/18/19/20 mm*	17/18/19/20 mm*	19/20 mm*

\*Depending on the type of roller blind.

The cassette is available in a number of designs in the M Series, including:

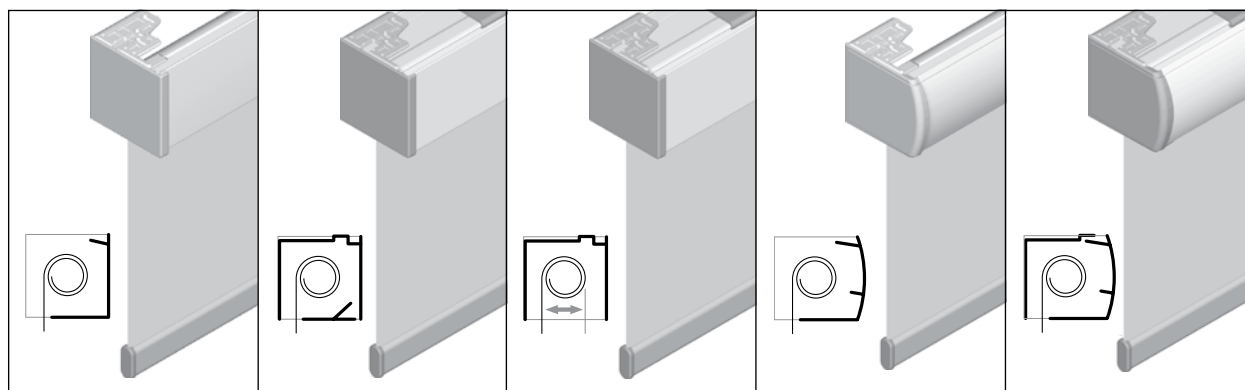

Straight valance (5-30)

Square cassette (5-70)

U cassette (5-90)

Design valance (5-300)

Design cassette (5-310)

Window Coverings  
Ceilings  
Sun Control  
Façades



China  
Hong Kong  
India  
Indonesia  
Japan  
Korea  
Malaysia  
Philippines  
Singapore  
Taiwan  
Thailand  
Vietnam

Australia  
Europe  
Latin America  
North America



Hunter Douglas Asia Operations  
Tel: +60 351 912 020

[www.hunterdouglas.asia](http://www.hunterdouglas.asia)



Copyright by Hunter Douglas.  
Technical data subject to change without notice.  
201006-4-1.0

©Registered trademark of Hunter Douglas